

BEGA**84 580**

Floodlight

IP 65

Project · Reference number

Date

Product data sheet

Application

Permanent cross beam with two small floodlights for installation on ceilings or walls in private sector.

Product description

Floodlight made of aluminium alloy,
aluminium and stainless steel
BEGA Unidure® coating technology
Matt safety glass with optical structure
Reflector surface made of pure aluminium
No tools are needed to adjust the
operating position
Rotation range of floodlight 270°
Swivel range 180°
Mounting plate with 2 elongated holes
Width 5.3 mm · Spacing 230 mm
2 cable entries for through-wiring of mains
supply cable \varnothing 7-10,5 mm,
max. 3x1.5[□]
Connecting terminal and
earth conductor terminal 2.5[□]
LED power supply unit
220-240 V \sim 0/50-60 Hz
DC 176-280 V
Safety class I
Protection class IP 65
Dust-tight and protection against water jets
CE – Conformity mark

Inrush current

Inrush current: 20 A / 80 μ s
Maximum number of luminaires of this
type per miniature circuit breaker:
B 10A: 35 luminaires
B 16A: 56 luminaires
C 10A: 58 luminaires
C 16A: 94 luminaires

Lamp

Module connected wattage	10.8 W
Luminaire connected wattage	12.7 W
Rated temperature	$t_a = 25^\circ\text{C}$
Service life criteria	50 000 h/L ₇₀

84 580 K3

Module designation	2x LED-1217/930
Colour temperature	3000 K
Colour rendering index	CRI > 90
Module luminous flux	1330 lm
Luminaire luminous flux*	920 lm
Luminaire luminous efficiency*	72,4 lm/W

* preliminary data

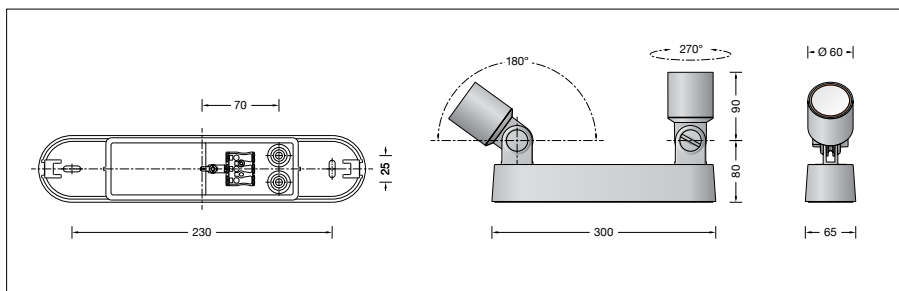
**Light technique**

Symmetrical wide beam light distribution
Half beam angle 32°
Luminaire data for the light planning program
DIALux for outdoor lighting, street lighting and
indoor lighting, as well as luminaire data in
EULUMDAT and IES format are available on the
BEGA website at www.bega.com.

Light distribution